

# THE BOURNE ACADEMY



Everyone is a learner, everyone is a teacher



# STUDENT HANDBOOK

# CONTENTS PAGE

**PAGE 3**

**Welcome to The Bourne Academy**

**PAGE 4**

**Areas of The Bourne Academy**

**PAGE 5**

**If you ever need help**

**PAGE 6**

**During Break and Lunch**

**PAGE 7**

**Important Adults**

**PAGE 8**

**Important Adults (continued)**

**PAGE 9**

**Year 7 Tutor Team**

**PAGE 10**

**School Day Timings**

**PAGE 11**

**Online platforms you'll use**

**PAGE 12**

**Essential Equipment**

**PAGE 13**

**Uniform**

**PAGE 14**

**FIC Cards**

**PAGE 15**

**Aspire Cards**

**PAGE 16**

**Map**

**PAGE 17**

**Key Dates**

# Welcome to **THE BOURNE ACADEMY**



THIS IS OUR  
MAIN  
ENTRANCE



THIS IS OUR  
RECEPTION



# Areas of THE BOURNE ACADEMY



THIS IS OUR  
MAIN  
CORRIDOR



THIS IS OUR  
OUTDOOR  
WALKWAY



THIS IS OUR  
HALL



# If you ever **NEED HELP**



**THIS IS OUR  
PASTORAL  
HUB**



**Visit at break or  
lunch if you need  
help and support**



**THIS IS OUR  
SEND OFFICE**

**Mr Cornish and  
Ms McHugh work  
here**



# During **BREAK & LUNCH**



YOU CAN  
ACCESS  
THE HUB

Food can be bought  
in here from  
'Cleverchefs'

AND THE LAWN

There will be  
seating at break and  
lunch



# Important ADULTS

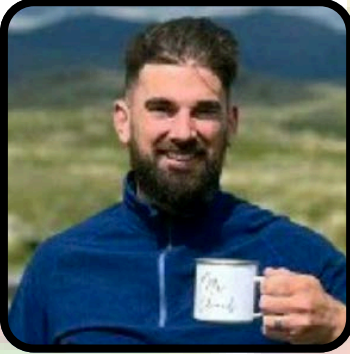

**MR EDWARDS (HEAD OF YEAR 7)**



**MR CORNISH**



**MS MCHUGH (SENDSCO)**



**MISS EASDEN**

# Important ADULTS



**MISS MURPHY (ELSA)**



**MISS SMITH**



**MRS FRANKLIN (ASSISTANT VICE  
PRINCIPAL)**



**MR ST JOHN (VICE PRINCIPAL)**



**MR AVOTH (PRINCIPAL)**



# Year 7 TUTOR TEAM



**MRS STOW (ANVIL)**



**MR GALLACHER (CALSHOT)**



**MISS MCCARTHY (HURST)**



**MRS PLUNKETT (KINGSWEAR)**



**MRS RENNIE (PORTLAND)**



**MISS SMITH (TRINITY)**

# SCHOOL DAY

*timings*



TIME	EVENT
8:30 - 8:40	Gates Open
8:45 - 9:10	Tutor Time
9:10 - 10:10	Lesson 1
10:10 - 11:10	Lesson 2
11:10 - 11:30	BREAK
11:30 - 12:30	Lesson 3
12:30 - 13:30	Lesson 4
13:30 - 14:00	LUNCH
14:00 - 15:00	Lesson 5
15:00 - 16:00	Lesson 6

- MONDAY
- TUESDAY / FRIDAY
- WEDNESDAY



TIME	EVENT
8:30 - 8:40	Gates Open
8:45 - 9:15	Tutor Time
9:15 - 10:15	Lesson 1
10:15 - 11:15	Lesson 2
11:15 - 11:35	BREAK
11:35 - 12:35	Lesson 3
12:35 - 13:35	Lesson 4

ON THURSDAYS  
YOUR LESSONS  
WILL FINISH AT 3PM  
AND YOU'LL HAVE A  
30 MINUTE "DEAR"  
SESSION FROM  
15:00 - 15:30  
WHERE YOU  
'DROP EVERYTHING  
AND READ'

Online  
**PLATFORMS**  
you'll use



**HERE YOU CAN CHECK YOUR  
TIMETABLE AND HOMEWORK.**



**ON SPARX  
YOU WILL  
COMPLETE ANY  
MATHS HOMEWORK**



**ON TASSOMAI  
YOU WILL  
COMPLETE ANY  
SCIENCE  
HOMEWORK**



**ON BEDROCK  
YOU WILL  
COMPLETE ANY  
ENGLISH  
HOMEWORK**

Essential  
**EQUIPMENT**  
to remember

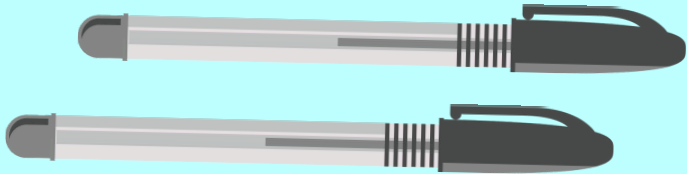

**2 BLACK PENS**



**1 GREEN PEN**

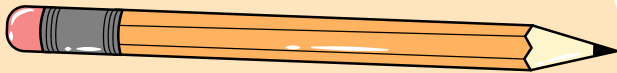

**A SHARP PENCIL**



**RUBBER**

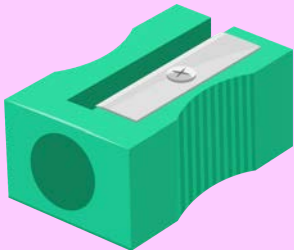

**SHARPENER**

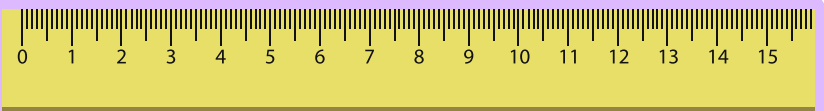

**15CM RULER**

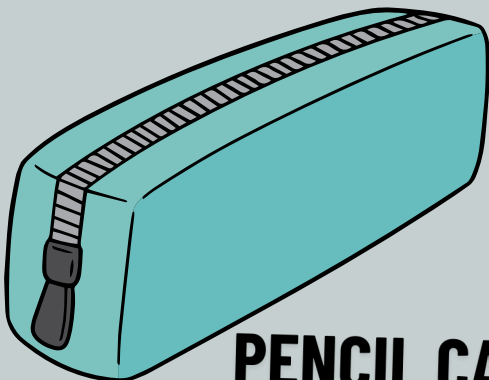

**PENCIL CASE**



**SCIENTIFIC  
CALCULATOR  
(YR 9-11)**

# UNIFORM



House Blazer



Jumper



White Shirt



House Tie



Pink Blouse  
(no tie needed)



Skirt



Black Trousers



PE Midlayer



PE Hoodie



PE Skort



PE Shorts



PE T-Shirt

# FIC CARDS

(First Impressions)



  
ASPIRE

**TBA First Impressions Card: Spring Term 2**

**Name:** \_\_\_\_\_ **Tutor** \_\_\_\_\_

**Group:** \_\_\_\_\_

Expected Impression	Infringement	Infringement	Infringement	Infringement	Infringement
1. Fully equipped	Date Staff	Date Staff	Date Staff	Date Staff	Date Staff
2. Punctual to line-ups and lessons	Date Staff	Date Staff	Date Staff	Date Staff	Date Staff
3. Correct uniform	Date Staff	Date Staff	Date Staff	Date Staff	Date Staff
4. Social time conduct	Date Staff	Date Staff	Date Staff	Date Staff	Date Staff
5. Tutor time participation in the Reading Programme	Date Staff	Date Staff	Date Staff	Date Staff	Date Staff
6. Conduct around the Academy	Date Staff	Date Staff	Date Staff	Date Staff	Date Staff

 ment 1 2 3 4 5                      Date: \_\_\_\_\_  
 Sent to Isolation by: ..... (Staff Initials)

**If you don't meet the above expectations, you will receive a strike on your FIC card.  
If you get 5 strikes, you will be sent to our reflection room.**

**In certain cases, FIC cards can be adjusted to meet student needs.**

# ASPIRE

Card



## ASPIRE Reward Card

Name:

Tutor Group:

<b>A</b>	<b>Ambitious</b>	Staff: Date:	Staff: Date:	Staff: Date:	Staff: Date:	Staff: Date:
<b>S</b>	<b>Self-Confident</b>	Staff: Date:	Staff: Date:	Staff: Date:	Staff: Date:	Staff: Date:
<b>P</b>	<b>Physically Literate</b>	Staff: Date:	Staff: Date:	Staff: Date:	Staff: Date:	Staff: Date:
<b>I</b>	<b>Independent</b>	Staff: Date:	Staff: Date:	Staff: Date:	Staff: Date:	Staff: Date:
<b>R</b>	<b>Resilient</b>	Staff: Date:	Staff: Date:	Staff: Date:	Staff: Date:	Staff: Date:
<b>E</b>	<b>Emotionally Literate</b>	Staff: Date:	Staff: Date:	Staff: Date:	Staff: Date:	Staff: Date:

Once completed take your card to your Head of House to be rewarded with house points

When you follow our ASPIRE qualities, you can get your reward card signed off.

Upon completion you can earn extra house points.



SPORTS FIELDS

# SCHOOL MAP

**AREAS OF LEARNING**

**STEM:**

- Science
- Technology
- Engineering
- Maths
- Computing
- Business Studies
- Child Development
- Food

**AWE:**

- ART
- Photography
- Media
- Dance
- Drama
- Music
- Sport
- Outdoor Education

**HUMAN UNDERSTANDING:**

- History
- Geography
- Psychology
- Religious Studies
- Sociology
- Criminology

**COMMUNICATION & ENQUIRIES:**

- English Language
- English Literature
- Library
- Languages

**MISC.,**

- Reception
- The Hall
- The Hub
- The Lawn
- SEND/Bridge
- Reflection
- 6<sup>th</sup> Form Centre
- Head of House
- Head of Year 11
- Pastoral Support Hub
- General offices

★ **Toilets**

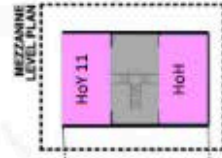
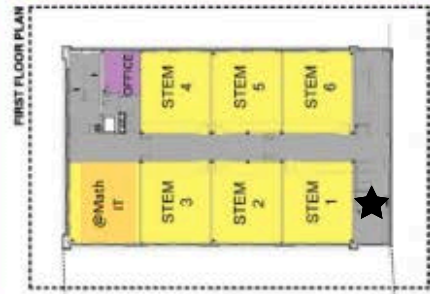



# KEY DATES

## July 2024

SUN	MON	TUE	WED	THU	FRI	SAT
	1	2	3	4	5	6
7	8	9	10	11	12	13
14	15	16	17	18	19	20
21	22	23	24	25	26	27
28	29	30	31			

## August 2024

SUN	MON	TUE	WED	THU	FRI	SAT
				1	2	3
4	5	6	7	8	9	10
11	12	13	14	15	16	17
18	19	20	21	22	23	24
25	26	27	28	29	30	31

## September 2024

SUN	MON	TUE	WED	THU	FRI	SAT
1	2	3	4	5	6	7
8	9	10	11	12	13	14
15	16	17	18	19	20	21
22	23	24	25	26	27	28
29	30					

SUMMER HOLIDAYS

SCHOOL STARTS

Sept 2nd and 3rd  
INSET DAYS

Last two days of summer for  
pupils

Sept 4th

Year 7 only  
on site

Sept 5th

Year 7 & 12  
only on site

Sept 6th

ALL YEARS  
in school